

GILDED BALLOON TEVIOT

THE LOUNGE

TECHNICAL SPECIFICATIONS 2026

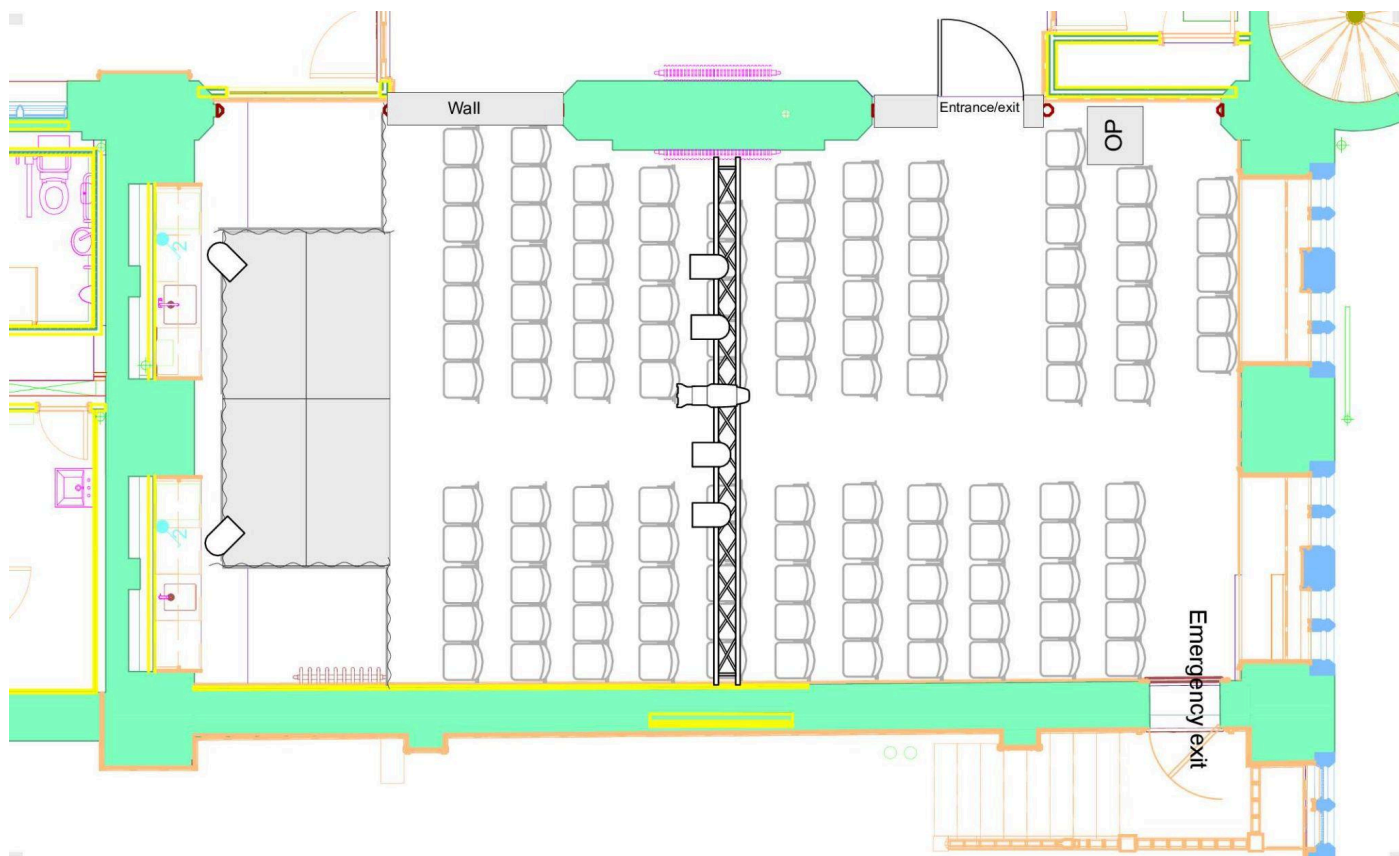

SEATING

- The Lounge has a total of 120 seats.

STAGE

- The stage is raised 300mm above floor level.
- The performance area is approximately 4m wide by 2m deep.
- There is limited space on either side of the stage behind the drapes.

MASKING

- The rear walls of the stage are draped behind them is almost immediately a wall.

SUSPENSION

- There are no flying facilities in the Lounge.

***Please note: All tech specs are subject to small changes as new venues plans are finalised.**



LIGHTING

- The control position for both lighting and sound is located at the rear of the venue, house left.

<i>Equipment</i>	
CONTROL	ETC EOS Console.
DIMMING	NONE

- This venue uses low power LED fixtures. All can mix most colours.
- There is a centre stage spot focused with a semi-hard edge to provide light for a single performer.

The standard venue rig cannot be refocused in any way.

- Additional lanterns can be rigged as company specials, but due to rigging, power and weight limitations, any rigged equipment must be approved for use before arrival.
- Blackout is acceptable, 'full' blackout is not possible due to emergency lighting regulations.

General Information

- Additional lanterns can be rigged as company specials, but due to rigging and power considerations these must be approved for use before arrival. As well as fixtures, cabling for any extras must be provided to reach the dimmers or stage boxes (please get in touch to discuss prior to arrival).
- All electrical equipment brought into the venue must be PAT tested.
- If you would like any help sourcing additional fixtures, please contact the production team at production@gildedballoon.co.uk.

The above information is subject to change - for the most current plans and specifications, to discuss company specials or for any other Lighting related queries please get in touch with the Production Manager at: production@gildedballoon.co.uk



SOUND

- The control position for both lighting and sound is located at the rear of the venue house Right

<i>Sound Equipment</i>	
CONTROL	Yamaha DM3
AMPLIFICATION	1 x NEXO NX4X1 POWER AMPLIFIER 2 x NEXO ID24 SPEAKER
PLAYBACK	1 x Via supplied PC DI box and Mini Jack cable
MICROPHONES & STANDS	2 x MTR DI Box 3 x Tall black microphone stands 3 x Shure SM58
CABLING	Various microphone and Jack cables

We provide an audio system of good, undistorted, even coverage across the entire seating area sufficiently powerful to satisfy most productions. If you feel that you have specific requirements regarding the sound system in a venue, please be in touch with our Production Manager at: production@gildedballoon.co.uk

Please Note: Prior to your arrival, a professional audio engineer tunes the audio rig in each venue. This system cannot be refocused or amended in any way.

Radio Microphones

- If you would like Gilded Balloon to source radio mics for your show, you can do so in the technical questionnaire on Eventotron.
- If you are bringing your own radio mics please indicate so in your technical questionnaire on Eventotron.
- Gilded Production will coordinate radio mic frequencies across their sites and deal with all radio mic frequency licensing.

If you need to purchase a radio microphone licence for the duration of the festival please contact the Production Manager at: production@gildedballoon.co.uk who will be able to help you through the process.

PROJECTION

There is no projector available as standard as a part of the venue kit. If you have vision requirements you can let us know when you complete your technical survey, and our team will be in touch to discuss and provide quotes for equipment.



GB TECHNICAL OPERATOR FEES

- If you request a member of the Gilded Balloon technical team to operate lighting and/or sound cues, this service will be charged at a rate of £30 plus VAT per performance. Please note that it may not be the same member of the technical team across all performances.
- Visiting companies are welcome to bring their own qualified technicians but must ensure the person designated for the role is suitably technically competent to operate the venue equipment. If the production is technically complex, we would recommend bringing your own technical operator.
- If you need additional support during turnarounds and need extra members of staff, we can provide this at a rate of £15 plus VAT per performance.

Service	What's included	Cost (charged at settlement)
Technical Operator	Turnaround assistance and full operation of sound and/or lighting cues throughout the show.	£30 + VAT per performance

DRESSING ROOM

- There is no dressing room for this space.

STORAGE

- There is a limited storage area outwith the venue.
- All set items must easily pass through a standard single door.

ACCESS

The Lounge is located at: Gilded Balloon
 Teviot Row House
 13 Bristo Square
 Edinburgh
 EH8 9AJ

- Teviot Row House is vehicle accessible via Charles Street Lane via Crichton Street.
- Entry for loading is from the rear lane, through 4 sets of standard width doors, and up a set of stairs.
- There is no parking at Teviot Row House.



ACCESSIBILITY

- Please visit the [accessibility page](#) on the Gilded Balloon website for more information or contact us if you have any further queries regarding accessibility.

SECURITY

Please remember that this is a festival environment. We cannot accept any responsibility for any items lost or stolen within the building. We work hard to ensure the venues are safe and recommend the following:

- That you do not leave any valuable personal items in the venue.
- That you take any valuable items away with you every day.
- That electronics should not be left in the venue, unless they are wired into our system for your production.

TECHNICAL QUESTIONNAIRE

Once your show has been registered with the Fringe and contracted, you will receive a link to fill in our technical questionnaire. This is your opportunity to give as much information as possible on the technical requirements for your show. You will be asked if you wish GB to provide an operator or will be providing one yourself as well as all sound, lighting and AV requirements for your show. It will also ask for an indication of your technical rehearsal requirements.

If any additional technical equipment is required for your show, you can indicate it on the questionnaire and a quote will be provided in advance of the Fringe for you to confirm. If this is not filled out by the deadline given, there is no guarantee we can provide what is needed for your show.

NOTES

- There are no wardrobe or laundry facilities at Teviot Row House.
- Any additional staff or items of equipment, which the management are requested to provide will be charged to the visiting company.
- Any electrical equipment you wish to use must have a current PAT certificate dated less than 12 months prior. All electrical items must also be cleared with us before use. We reserve the right to refuse the use of any equipment, which is deemed unsafe.
- Each company is assigned a get in/rehearsal time prior to their first performance. This is the time for you to load your set and props into the venue and to re-tech your show. This time is also for the venue technician to learn the requirements of your production
- You will need to allow enough time to rehearse your daily turnaround and set storage. Please note that your time slot must include get-in and get-out time.



- All use of naked flames, smoke, haze, strobe, laser or pyrotechnic effects must be cleared with management before bringing them onsite. Smoking is not permitted in any venues, on or offstage.
- At the end of the festival, please arrange for removal or disposal of your set and any unused publicity material. Any company who does not comply will be charged for the cost of disposal. The base charge for disposal is £200 but may be increased.
- Please note, since this is a temporary conversion and not a permanent performance space, all measurements and quantities quoted in the above specification are approximate and may be subject to change.
- Venue specifications may be subject to minor changes.

If there is anything specific to your show that you would like to discuss with the production team that cannot be clearly communicated in the technical questionnaire, please email them on production@gildedballoon.co.uk